

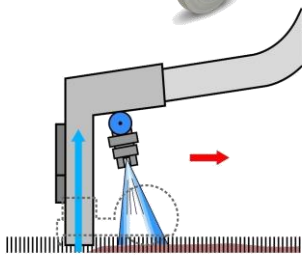

GraceHP-Silent is a high-performance carpet extractor, with a 28 Bars piston pump and 2 high-waterlift vacuum motors. Its **high-waterlift** vacuum system allows to recover the maximum quantity of dirt from carpet and to get a shortest drying time. The high pressure flow allows to remove the dirt more easily from carpet fibres. The two tanks, 70 litres each, enable a long autonomy of operation. GraceHP-Silent is particularly indicated for professional carpet cleaners. Dedicated brackets allow to hang hoses and wand on the machine, to easily move the complete machine from site to site.

It can be supplied with the instant hot water unit HT1800-HP and with one of the optional power brush wands. GraceHP-Silent is supplied with an integrated patented system, allowing automatic chemical dosing, carpet pre-spraying and rinsing.

Main application fields: cleaning companies.



Injection-extraction cleaning

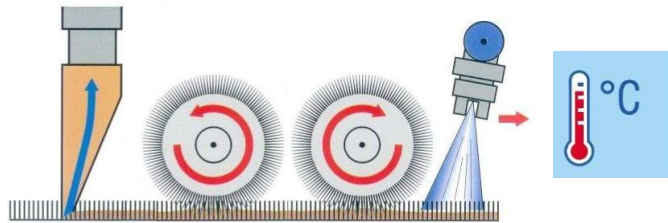

Injection-extraction with NS400BR-DUAL-HT

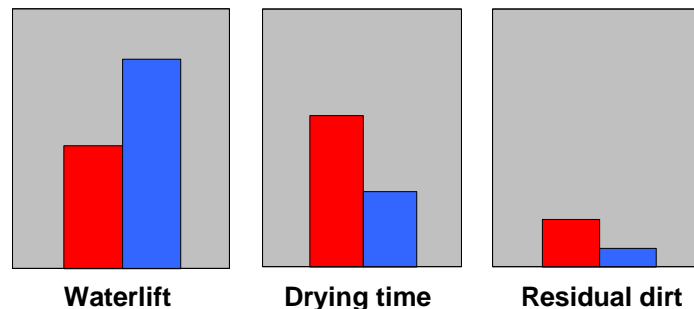

■ GraceHP- Silent
■ Standard carpet extractors

Advantages of Grace HP:

1. **High-waterlift** technology allows incomparable dirt removal and shortest drying time: carpet can be dry in 1 hour!
2. **Long working autonomy** thanks to the big tanks, 70 litres each.
3. **Very silent working (60 decibels)**, that allows to use the machine with no discomfort for the worker and for other people. The machine can be used also during normal daily working time and in places sensitive to noise such as hotels, offices, banks.
4. Carpet tool with aluminium vacuum head, practically **indestructible**.
5. **Special profile** of the vacuum head, which allows to get the best suction even when the tool inclination changes.
6. The height of the handle is **adjustable**, for greater ergonomics. The handle allows the worker to lift the tool and to press the vacuum head down on carpet with a very small effort.
7. **Spraying valve** designed for avoiding any breaking.
8. Tubes in **stainless steel**, strong and rustproof for the whole machine life.
9. **Quick disconnect** spray nozzles, which can be removed by hand, without using any tool. The nozzles can be cleaned easily.
10. The machine allows to perform **automatic chemical dosing and carpet rinsing**.
11. Using one of the **optional power-brush wands**, it is possible to get excellent cleaning results, leaving carpet perfectly clean and dry in a single pass.
12. Thanks to an integrated patented device it is also possible to **pre-spray carpet** before cleaning.
13. With the optional vacuum tool **NS270TURBODUST**, it is possible to vacuum dust before cleaning, with the same machine.



Other technical advantages of GraceHP-Silent:

1. Detachable tanks. The machine can be carried easily even in a small car.
2. High density polyethylene tanks, very strong and made for lasting a long time.
3. Transparent unbreakable cover, which allows to see the dirty water while it is sucked.
4. Easy to reach hole for filling the tank with clean water.
5. Drainpipe for easily emptying the recovery tank.
6. The gaskets are replaceable by hand since they are not glued. Easy to clean and change.
7. Strong wheels, in antimark rubber.
8. Brass quick-disconnect couplings, reliable and strong.
9. Vacuum motors with thermal protection against overload.
10. Vacuum motors treated against rust.
11. Both motor and pump can work continuously.
12. Modular design that makes the maintenance easier. The maintenance of the machine can be done at low costs.

Technical Data

Approximate performance (basic machine)*:	60-110 m²/h
Approximate performance (professional SET)*:	170-240 m²/h
Recovery tank capacity:	70 liters
Solution tank capacity:	70 liters
Vacuum motor:	2 motors - 3 stages - High Waterlift
Power:	2 x 1500 W
Maximum waterlift:	3400 mm H ₂ O
Maximum air-flow:	90 l/sec.
Pump with by-pass:	Piston
Power:	180 W
Maximum pressure:	28 bar (adjustable)
Maximum water-flow	4,5 l/min
Cleaning width:	300 mm
Number of nozzles:	3
Cable length:	10 m
Hose length:	7,5 m
Weight (machine body):	80 kg
Weight (packaged machine):	95 kg
Dimensions:	50 x 89 x 98 cm
Package dimensions:	60x95x112cm
Standard colors:	Blue
Tank construction:	High density polyethylene
Suitable to work with heater HT1800-HP :	YES

*The effective performance depends on the type of cleaning required: restorative deep cleaning - maintenance cleaning.

Complete machine with hoses H35-RAGNOL75-T + carpet tool NS300-USA	€
--	---



Suggested optional tools (see also GraceHP-Silent PROFESSIONAL SET)

	NS10ALL-HP	Aluminium hand tool, with 1 spray nozzle – high pressure type	€
	HT1800-220-HP	Instant hot water unit, 1800W, 10m separate cable, complete with metal brackets to fix it on the machine.	€
	NS400BRUSH	Special wand, 400mm wide, with a cylindrical rotating brush, to be used for cleaning carpet in combination with an injection-extraction machine	€
	NS400BR-DUAL	Special wand for carpet cleaning, with 2 counter-rotating cylindrical brushes. This wand can be used with any Santoemma injection-extraction machine.	€
	NS400BR-DUAL-HT	Special wand for carpet cleaning, with 2 counter-rotating cylindrical brushes. An incorporated instant heating system allows to instantly heat the cleaning solution sprayed on carpet. This wand can be used with any Santoemma injection-extraction machine.	€
	9022	Hose for filling up the clean water tank easily. It can be used to connect the water tap to the machine tank, without spilling water.	€
	ST810	Three speed air blower, high performance, 1 Hp, 230V – 50Hz, for quick drying of carpet after cleaning. Equipped with wheels and extensible handle, easy to transport. Stackable.	€



GraceHP-Silent PROFESSIONAL SET

Up to
240
sqm/h

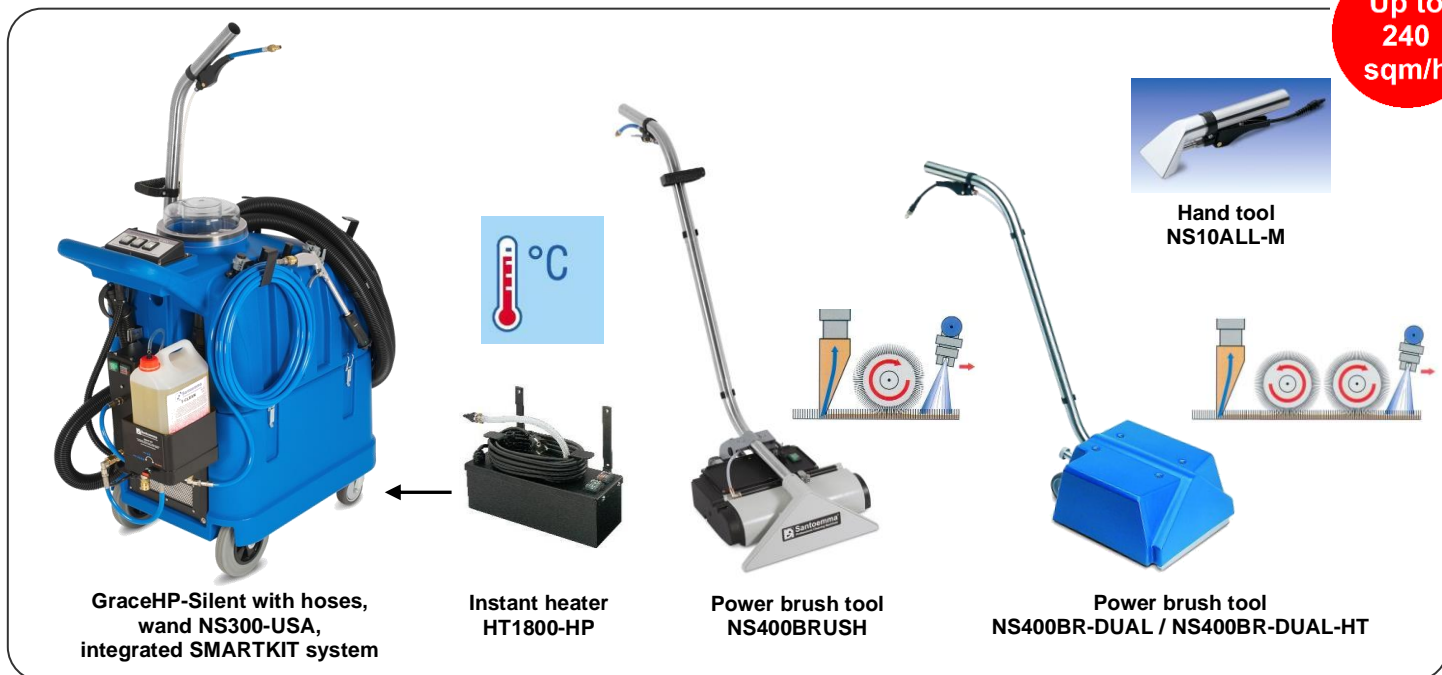

GraceHP-Silent PROFESSIONAL SET includes:

- Machine body and hoses H35-RAGNOL75-T
- The wand NS300-USA
- The aluminium hand-tool NS10ALL-HP, for cleaning upholstery and hard-to-reach spots
- The instant hot water unit HT1800-220-HP
- Integrated SMARTKIT patented system, to perform automatic chemical dosing, carpet pre-spraying and rinsing
- One of the power brush tools: NS400BRUSH, NS400BR-DUAL or NS400BR-DUAL-HT

Advantages with Grace HP PROFESSIONAL SET:

1. The mechanical brushing action gives an excellent cleaning result, removing dirt completely from the base of carpet fibres. No residual dirt will re-emerge on carpet surface after few days!
2. Even a very dirty carpet can be completely clean in a single pass, reducing the time of cleaning operations.
3. Being able to clean in single pass, the amount of solution sprayed on carpet is not excessive and can be completely recovered by the machine's high-waterlift vacuum system. As a result, carpet can be completely dry in one hour!

Complete **Grace HP Professional set**, including:

machine body, hoses **H35-RAGNOL75-T**, carpet tool **NS300-USA**, hand tool **NS10ALL-HP**, instant heater **HT1800-220-HP**

Integrated **SMARTKIT patented system** for automatic chemical dosing and rinsing, with pipe and pre-spray gun and one of the following power brush tools:

- | | |
|---|---|
| A) Power brush tool NS400BRUSH with 1 rotating rotating brush | € |
| B) Power brush tool NS400BR-DUAL with 2 counter-rotating brushes | € |
| C) Power brush tool NS400BR-DUAL-HT with 2 counter-rotating brushes and internal instant heater. | € |